

Lamtec FSKF	
	Attenuation
Average	73.0
Minimum	63.1
Maximum	78.5
Median	73.3

Lamtec FSKF Perforated	
	Attenuation
Average	73.0
Minimum	63.0
Maximum	77.9
Median	73.3

- 2 exposed layers of aluminum foil in a multilayered reinforced facing
- Provides RF shielding when installed on the perimeter building envelope and applicable interior walls
- Has an average greater than 70 dB of RF attenuation in accordance with IEEE 299
- Designed for Sensitive Compartmented Information Facility (SCIF) and other areas where TEMPEST mitigation enclosure is required
- Available perforated and non-perforated
- Flame Spread 15 and Smoke Developed 5 per ASTM E84 test method
- Supplied in 500sf rolls (51" x 118'), non-standard widths and lengths available
- Product meets the NSA minimum requirements for RF attenuation properties in accordance to ASTM D4935-99 per the NCSC

Lamtec FSKF

Foil Facing for Radio Frequency (RF) Shielding Applications

LAMTEC
CORPORATION

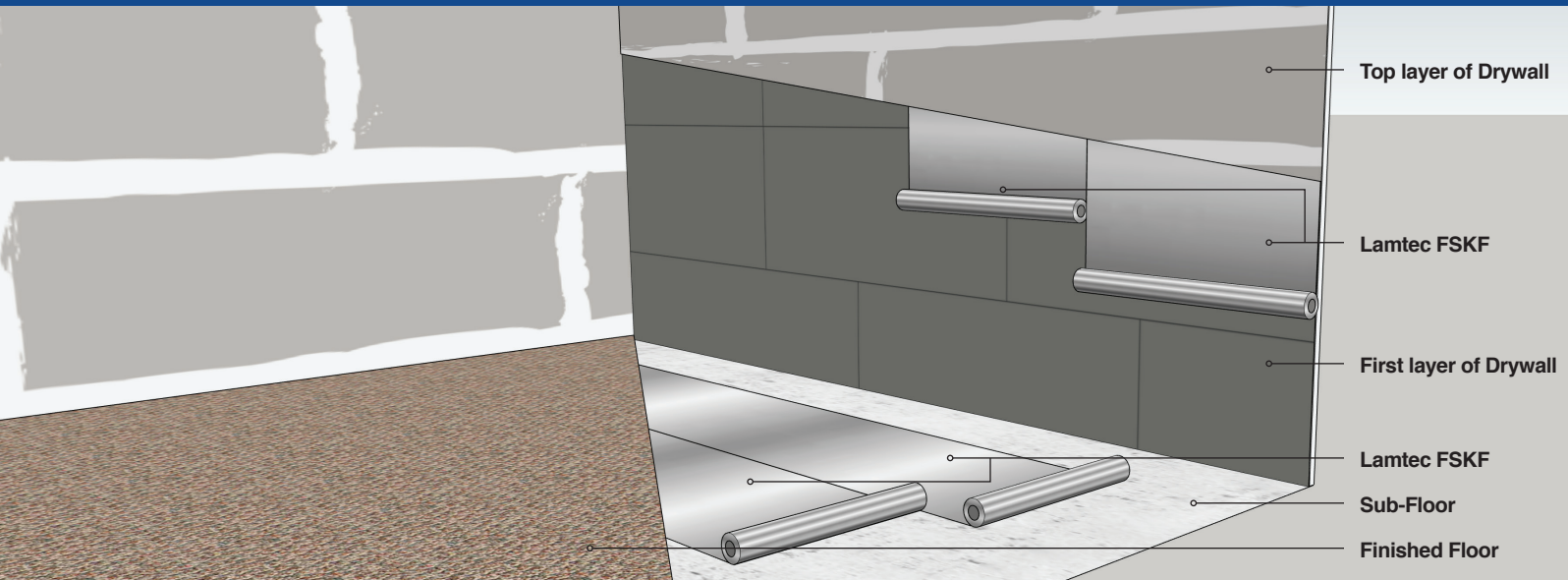

SCIF Installation Guidelines

At the direction of the technical authority, installation and location of Lamtec FSKF should be completed in accordance with the drawings, specifications, current standards for SCIF or published best practices for shielding for the project.

- The product should be installed continuously over all surfaces inside the controlled enclosure, at the direction of the technical authority.
- The product should be installed either vertically or horizontally over the framing.
- The product should be installed between layers of gypsum board walls, temporarily held in place with general purpose construction adhesive.

SCIF Guide Specification

Part 1. General

Performance Requirements

Construct a controlled enclosure in which RF signals are contained.

Install specified materials indicated to maintain the electrical continuity of the RF protection over the entire surface of the enclosure. Skill and attention to detail are critical.

Shielding Effectiveness:

1 GHz to 18 GHz · average 70 dB or greater

Part 2. Products

Lamtec FSKF

Manufacturer: Lamtec Corporation, Mt. Bethel, PA, 18343

Phone: 800-852-6832

Lamtec FSKF, or approved equal

Description

Multilayered highly reflective laminate of aluminum foil / fiberglass reinforcing / kraft paper / aluminum foil.

Flame Spread 15 and Smoke Developed 5 per ASTM E84 test method

Supplied in 500sf rolls (51" x 118"), non-standard widths and lengths available

Minimum 99% pure aluminum foil

Part 3. Execution

At the direction of the technical authority, install the Lamtec FSKF continuously on the controlled side of the enclosure. Vertical and horizontal seams must overlap a minimum of 3 inches and be sealed.

Seal all seams with approved conductive adhesive foil tape.

Repair all tears and punctures in the Lamtec FSKF with conductive adhesive foil tape.

Approved conductive tape is 2 inch wide 3M 3302 or equivalent.